

ÇS075

CABLE CARRIERS STEEL SERIES

Inner Height(A) 75mm	Code	Radius	(A)mm	(B)mm	(C)mm	(D)mm
<ul style="list-style-type: none"> Both up and bottom parts (bars) are openable Should be used in supporting tray Suitable for low speeds 	ÇS 075 100 R	100-500	75	100	98	140
	ÇS 075 125 R	100-500	75	125	98	165
	ÇS 075 150 R	100-500	75	150	98	190
	ÇS 075 200 R	100-500	75	200	98	240
	ÇS 075 250 R	100-500	75	250	98	290
	ÇS 075 300 R	100-500	75	300	98	340

Maximum working speed :0.5M/S

Radius MUST be given in your orders. Example:

ÇS 075 100 R100

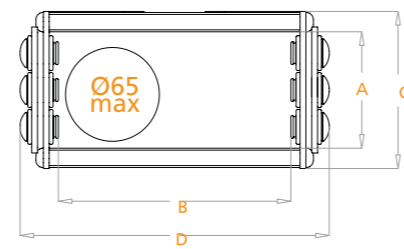

R mm	H mm	X mm	M mm	Y mm
100	90	298	149	494
500	90	1098	549	1750

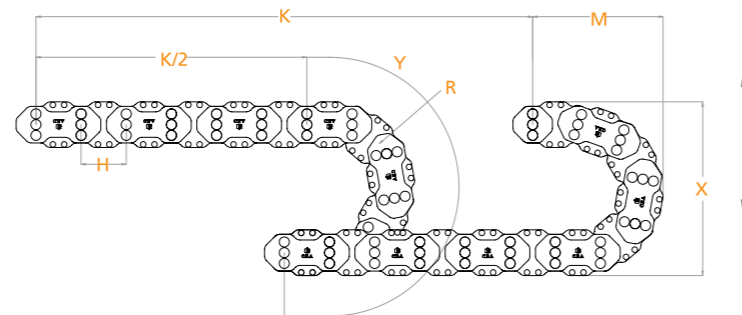

L: Total length to be used

K: Movement distance

Y: Radius

$$L: \frac{K}{2} + Y$$

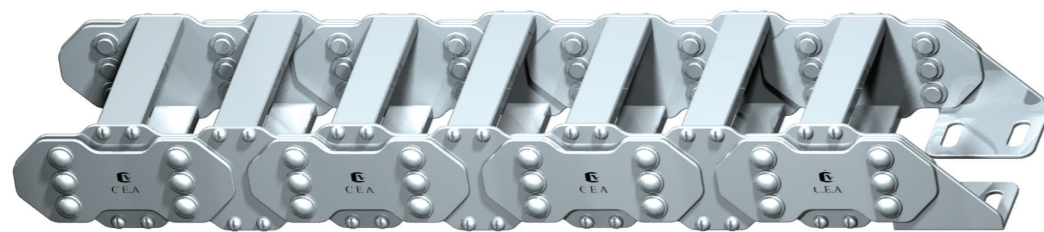

IMPORTANT POINTS

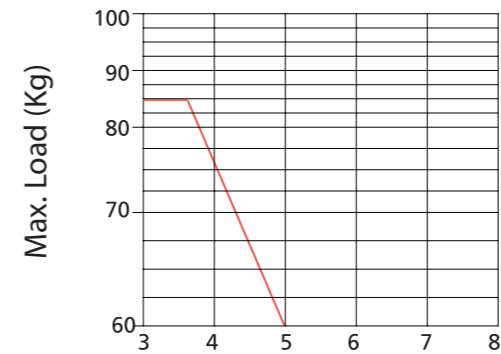

$$\frac{K}{2} \text{ Max. Length without support}$$

Self-supporting Capacity Diagram

Self-supporting capacity of the cable carrier according to weight of the cables and hoses

$$\frac{K}{2}$$

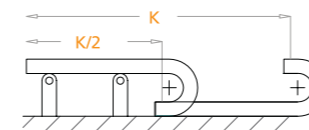

How to use support rollers:

- Special separators can be made upon request
- Can be made by stainless steel material upon request
- Should be used in supporting tray
- Be careful against strong knocks
- Be sure that diameter of hydraulic pipe is max 65 mm.

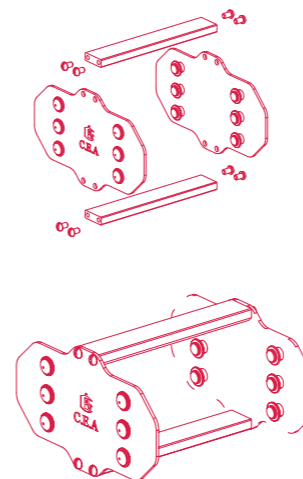

How to choose end bracket

End bracket

End brackets are the parts to be used to fix the cable carrier to the machine or equipment

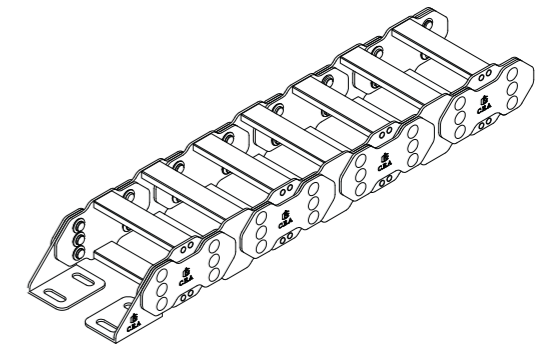

Should be attached to the both ends of the cable carrier

CABLE CARRIER CODE	END BRACKET CODE	A	B
ÇS 075 100 R	ÇS 075 100 B01	48	140
ÇS 075 125 R	ÇS 075 125 B01	73	165
ÇS 075 150 R	ÇS 075 150 B01	98	190
ÇS 075 200 R	ÇS 075 200 B01	148	240
ÇS 075 250 R	ÇS 075 250 B01	198	290
ÇS 075 300 R	ÇS 075 300 B01	248	340

